

Dreidel (colors blue and white unless specified)

1 (red)

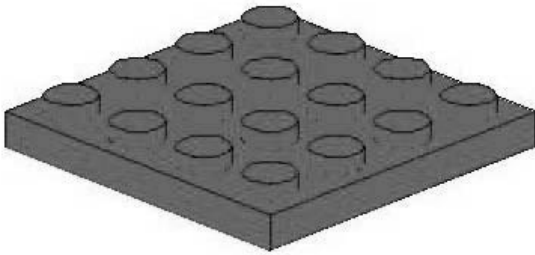

2

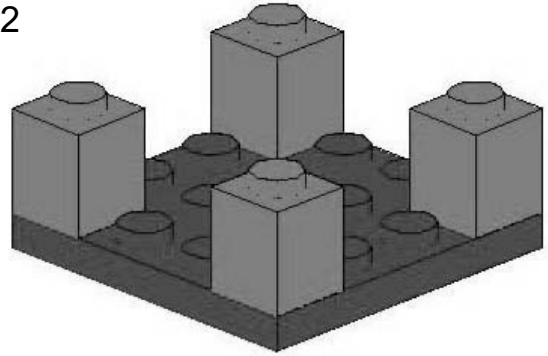

3 (add 1x2 bricks)

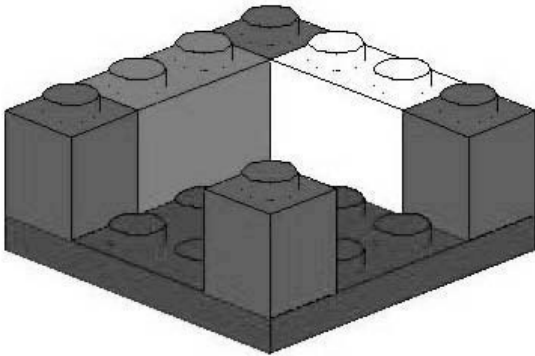

4 (add 1x2 bricks)

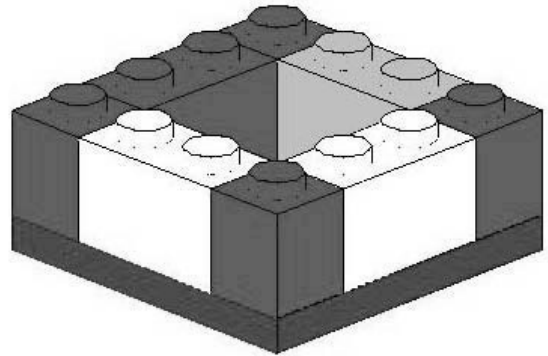

5 (remaining bricks will all be 1x1)

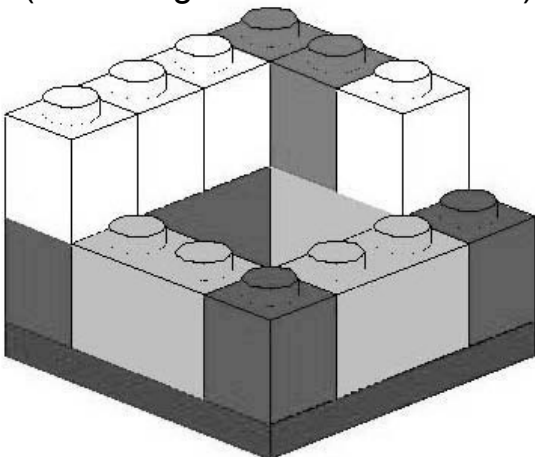

6

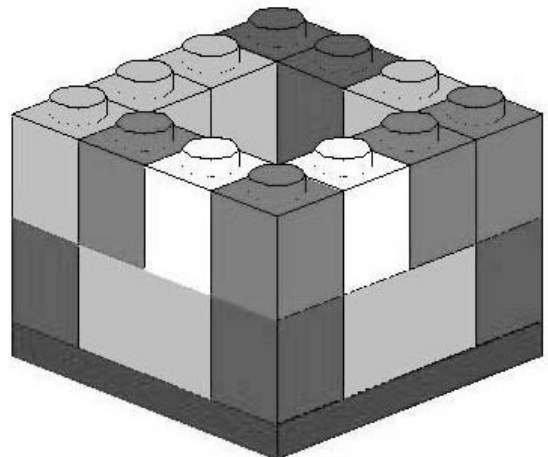

Dreidel (colors blue and white unless specified)

8

7 (brick at right end is yellow)

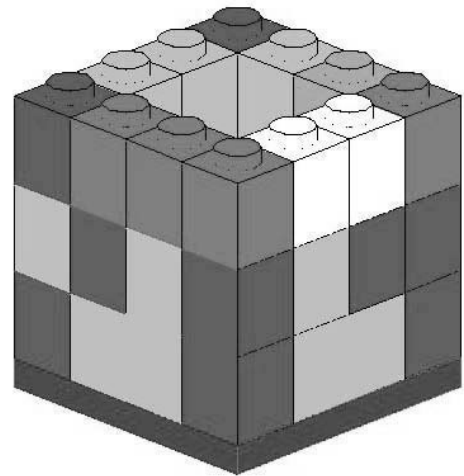
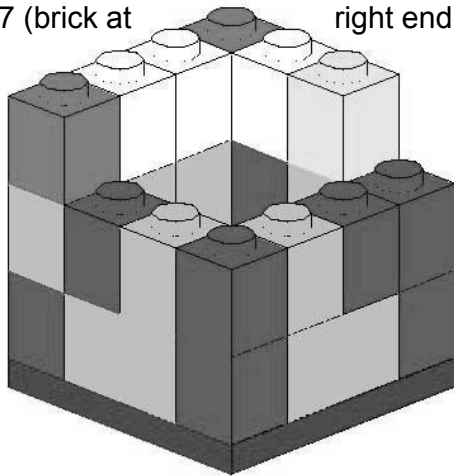

9 (red)

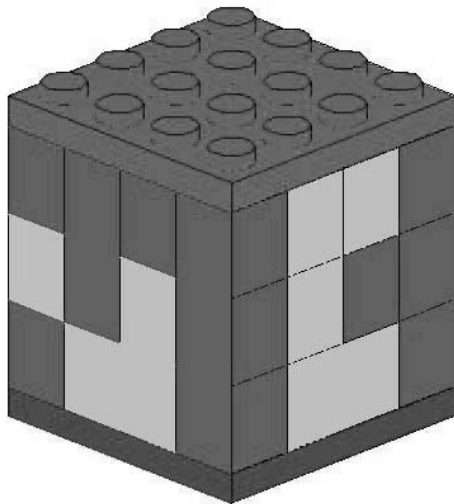

10

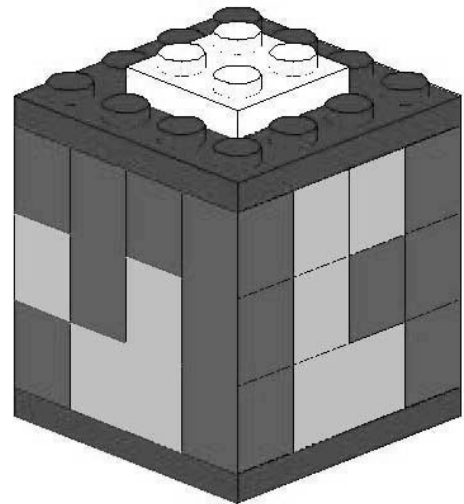

11 (yellow)

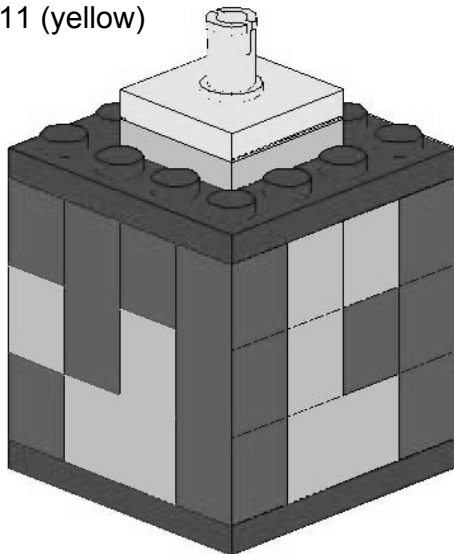

12 (just turn model upside down)

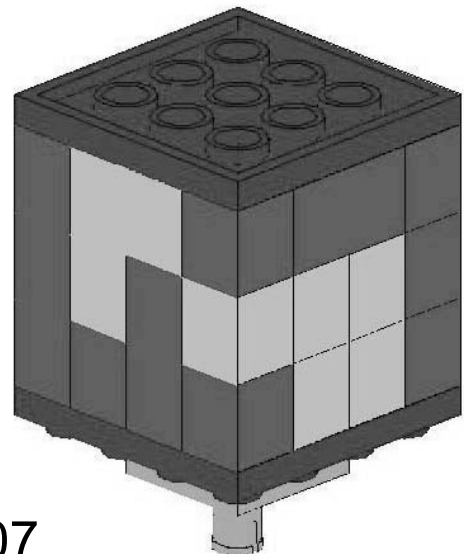

Dreidel (colors blue and white unless specified)

13 (starting handle; red)

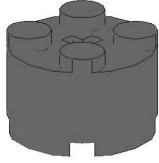

14 (yellow)

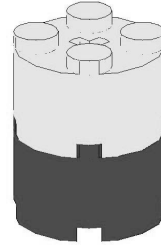

15 (add 2x2 round white plate)

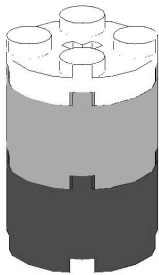

16 (red)

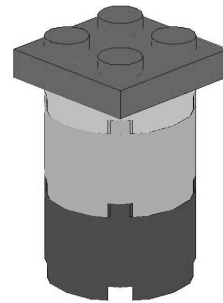

17 (turn handle upside down and attach to body)

