

Van Buren (088)	Jan 1 Owner	Current Owner	S/O BROCKDELL RD CO LINE		
Tax Year 2026 Reappraisal 2021	TRIPLE H REAL ESTATE LLC		Ctrl Map:	Group:	Parcel:
	1149 NEWMANS BRANCH ROAD		086		003.00
	MILTON WV 25541			PI:	SI:
					000

Value Information

Land Market Value: \$55,700
 Improvement Value: \$0
 Total Market Appraisal: \$55,700
 Assessment Percentage: 25%
 Assessment: \$13,925

Additional Information

WPP LLC MINERAL TRACT 46-6
 U

General Information

Class: 00 - Residential	City:
City #:	Special Service District 2: 000
Special Service District 1: 000	Neighborhood: N01
District: 04	Number of Mobile Homes: 0
Number of Buildings: 0	Utilities - Electricity: 01 - PUBLIC
Utilities - Water/Sewer: 12 - NONE / NONE	Zoning:
Utilities - Gas/Gas Type: 00 - NONE	

Outbuildings & Yard Items

Building #	Type	Description	Area/Units
------------	------	-------------	------------

Sale Information

Long Sale Information list on subsequent pages

Land Information

Deed Acres: 7.5 Calculated Acres: 0 Total Land Units: 7.5

Land Code	Soil Class	Units
03 - SMALL TRACT		7.50

Sale Information

Sale Date	Price	Book	Page	Vacant/Improved	Type Instrument	Qualification
10/22/2013	\$0	RB73	385		-	-
10/22/2013	\$0	RB73	294		-	-
9/24/2004	\$1	RB10	220	V - VACANT	WD - WARRANTY DEED	P - MULTIPLE PARCELS
7/1/1987	\$0	27T	292		-	-
1/2/1900	\$0	27N	14		-	-

Van Buren County - Parcel: 086 003.00

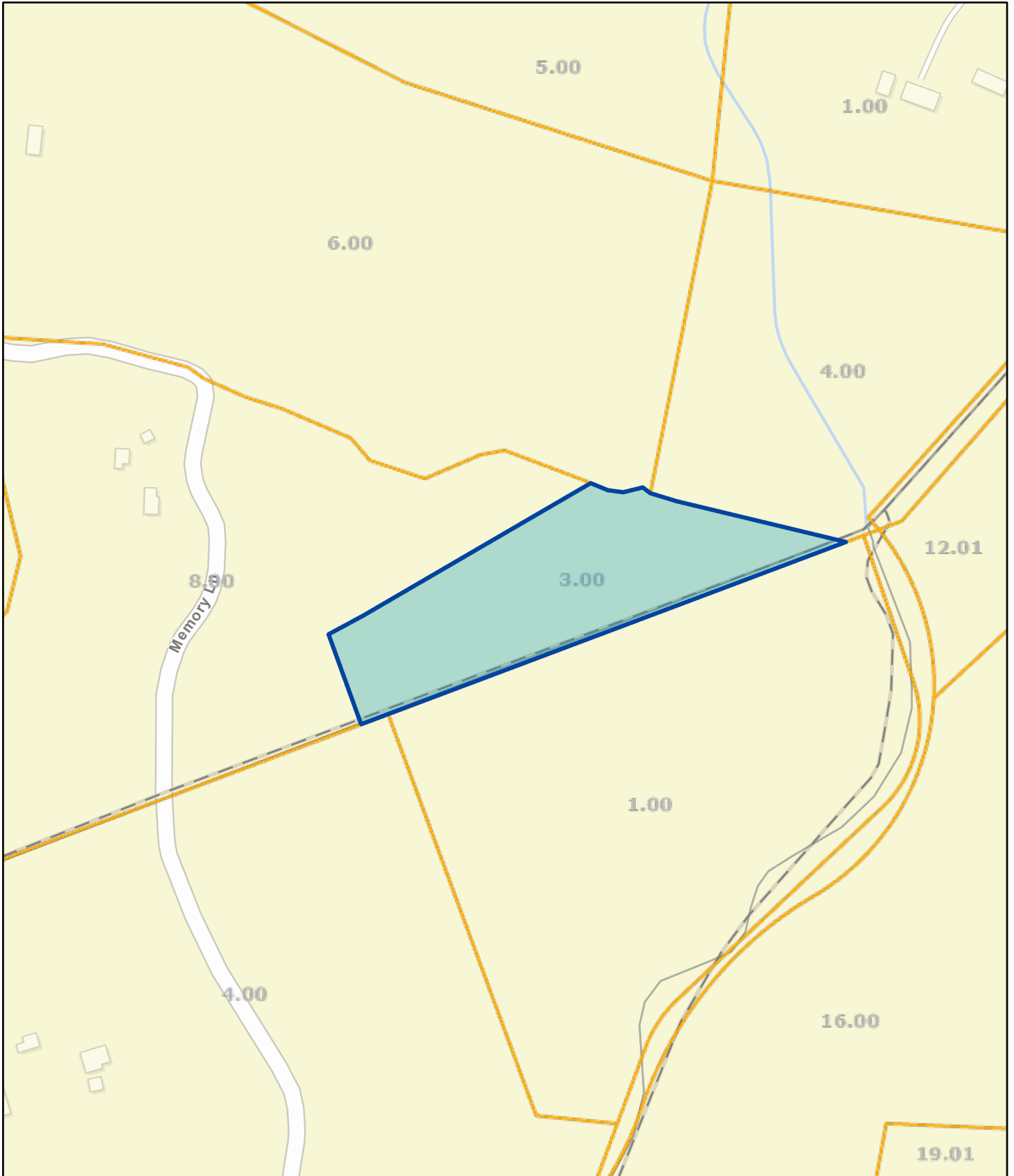

Date: March 24, 2026

County: VAN BUREN
Owner: TRIPLE H REAL ESTATE LLC
Address: S/O BROCKDELL RD CO LINE
Parcel ID: 086 003.00
Deeded Acreage: 7.5
Calculated Acreage: 0

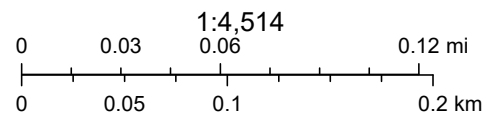

State of Tennessee, Comptroller of the Treasury, Division of Property Assessments (DPA), Esri Community Maps Contributors, © OpenStreetMap, Microsoft, Esri, TomTom, Garmin, SafeGraph, GeoTechnologies, Inc, METI/ NASA, USGS, EPA, NPS, US Census Bureau, USDA, USFWS

The property lines are compiled from information maintained by your local county Assessor's office but are not conclusive evidence of property ownership in any court of law.