

**Sequatchie (077)**

Jan 1 Owner

Current Owner

**S R 111 OFF**

**Tax Year 2025 | Reappraisal 2023**

TRIPLE H REAL ESTATE LLC  
1149 NEWMANS BRANCH ROAD  
MILTON WV 25541

Ctrl Map:	Group:	Parcel:	PI:	SI:
002		001.10		000

**Value Information**

**Land Market Value:** \$6,600  
**Improvement Value:** \$0  
**Total Market Appraisal:** \$6,600  
**Assessment Percentage:** 25%  
**Assessment:** \$1,650

**Additional Information**

TRACT 2 SURFACE ONLY  
POND 239-91

**General Information**

<b>Class:</b> 00 - Residential	<b>City:</b>
<b>City #:</b>	<b>Special Service District 2:</b> 000
<b>Special Service District 1:</b> 000	<b>Neighborhood:</b> R02
<b>District:</b> 02	<b>Number of Mobile Homes:</b> 0
<b>Number of Buildings:</b> 0	<b>Utilities - Electricity:</b> 00 - NONE
<b>Utilities - Water/Sewer:</b> 12 - NONE / NONE	<b>Zoning:</b> FLOOD
<b>Utilities - Gas/Gas Type:</b> 00 - NONE	

**Outbuildings & Yard Items**

Building #	Type	Description	Area/Units
------------	------	-------------	------------

**Sale Information**

Long Sale Information list on subsequent pages

**Land Information**

**Deed Acres:** 7.5      **Calculated Acres:** 7.5      **Total Land Units:** 7.5

Land Code	Soil Class	Units
23 - NONPROD		0.50
03 - SMALL TRACT		7.00

**Sale Information**

<b>Sale Date</b>	<b>Price</b>	<b>Book</b>	<b>Page</b>	<b>Vacant/Improved</b>	<b>Type Instrument</b>	<b>Qualification</b>
10/22/2013	\$0	313	715	V - VACANT	QC - QUITCLAIM DEED	P - MULTIPLE PARCELS
7/29/2010	\$0	284	822		RO -	P - MULTIPLE PARCELS
11/30/2007	\$58,650	239	91	V - VACANT	QC - QUITCLAIM DEED	-

# Sequatchie County - Parcel: 002 001.10

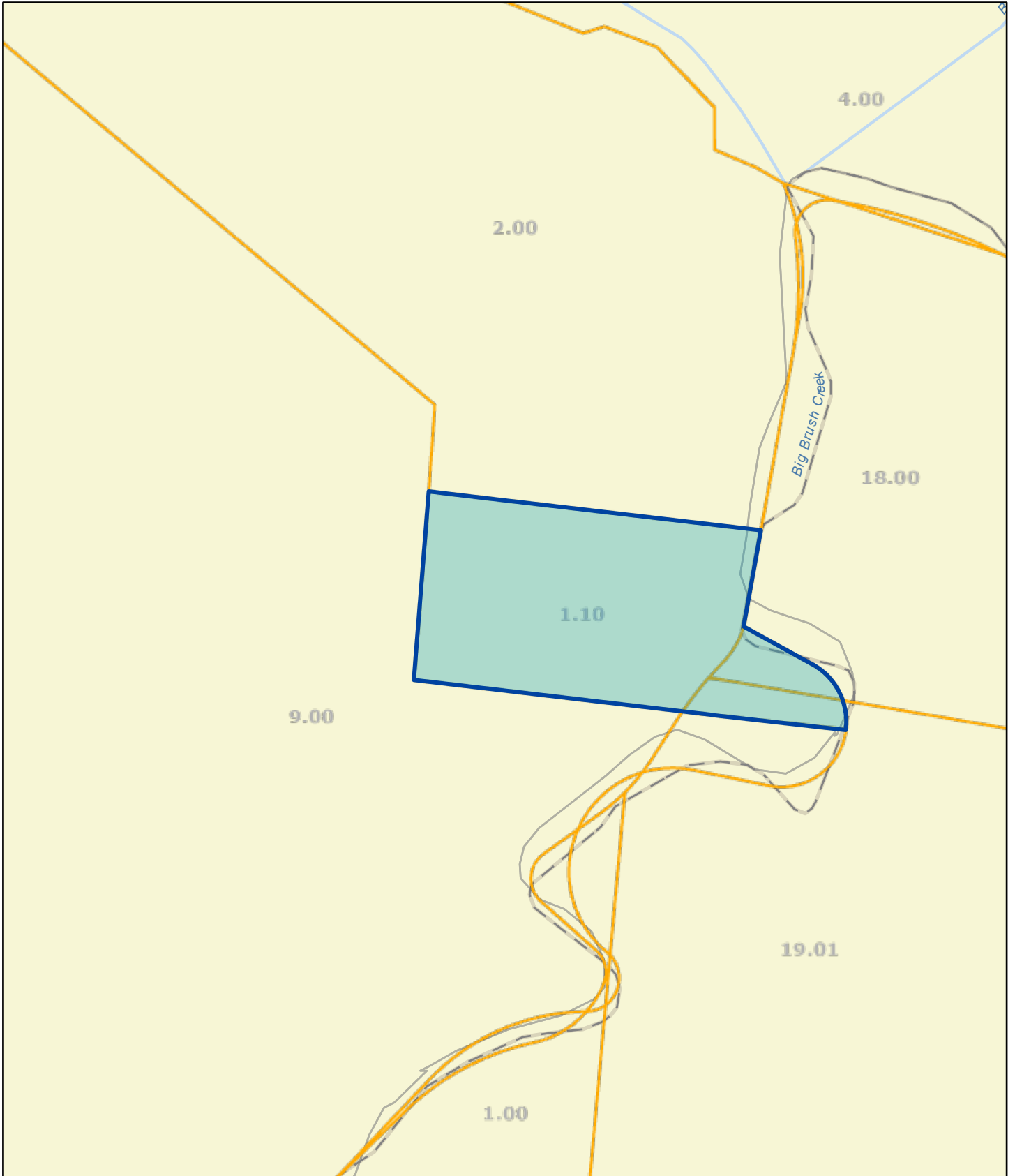

Date: March 24, 2026

County: SEQUATCHIE  
Owner: TRIPLE H REAL ESTATE LLC  
Address: S R 111 OFF  
Parcel ID: 002 001.10  
Deeded Acreage: 7.5  
Calculated Acreage: 7.5

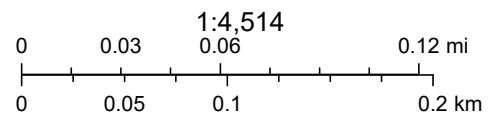

State of Tennessee, Comptroller of the Treasury, Division of Property Assessments (DPA), Esri Community Maps Contributors, © OpenStreetMap, Microsoft, Esri, TomTom, Garmin, SafeGraph, GeoTechnologies, Inc, METI/ NASA, USGS, EPA, NPS, US Census Bureau, USDA, USFWS

The property lines are compiled from information maintained by your local county Assessor's office but are not conclusive evidence of property ownership in any court of law.